

**27<sup>th</sup> Annual International Symposium**  
on Man and His Environment in Health and Disease

**FOCUS**  
**Nutritional &  
Environmental Aspects  
of Cardiovascular Disease**

**June 25-28**

**2009**

This event is jointly sponsored by the University of North Texas Health Science Center Office of Professional and Continuing Education and the American Environmental Health Foundation.  
20.5 AMA PRA Category 1 Credit(s)<sup>™</sup>, Category 2A, AOA and 20.5 Type 1 Contact Hours TNA/ANCC

**Exhibitor Prospectus**

## Dear Exhibitor,

We hope you and your organization will join us in Dallas on June 25-28, 2009, for the **27th Annual International Symposium on Man and His Environment in Health and Disease** at the Crowne Plaza Hotel North Dallas/Addison.

The Symposium is the most advanced Conference in the U.S. providing a forum for information on the impact of environmental factors on health and disease. The special focus of the upcoming Conference is “Nutritional and Environmental Aspects of Cardiovascular Disease.” Our meeting is co-sponsored by the University of North Texas Health Science Center at Fort Worth and attracts physicians, scientists, and health professionals from across the globe. This year’s faculty is composed of many of today’s most respected U.S. and international experts in medicine, health care, and the environment.

For the upcoming Symposium, we have arranged facilities at the Crowne Plaza Hotel that offer high visibility and comfort to our Exhibitors. The Exhibit Area will serve as the congregation point for all morning and afternoon breaks and the Exhibitors Sponsored Buffet Lunch on Saturday. The Environmental Health Center-Dallas will also sponsor a reception Friday evening in the Exhibit Room for all attendees.

**We have included a complete prospectus for your reference. As space is limited, we recommend that you return the following as soon as possible.**

- **Application form with booth requirements and space selection**
- **Exhibit fee**

## 27<sup>th</sup> Annual International Symposium

Exhibit space will be assigned on a first-come, first-served basis. The conference begins on Thursday, June 25 and ends on Sunday, June 28, 2009. The exhibit area will be open Friday and Saturday (June 26-27, 2009). Exhibit setup will be Thursday, June 25, 2009 between 1 p.m. and 6 p.m. Exhibitors may breakdown either Saturday evening June 27, 2009, after 7 pm or Sunday, June 28, 2009 following the closing of the conference. Your exhibitor fee includes participation in all of the conference functions beginning on Thursday, June 25, 2009 morning for two employees thru the close on Sunday.

We do hope that you will be able to join us for this exciting meeting. Please contact me if you have any questions regarding the Symposium or the enclosed material.



Sincerely,  
**David Hicks**

# Exhibit Information

## Exhibit Space

8' x 10' booth – includes two chairs, one eight foot table, and trash can. The exhibit room is carpeted. (Electricity for your booth is extra and can be ordered from the Crowne Plaza.)

## Exhibit Location Hotel Information

Crowne Plaza, Trinity Ballroom I-IV  
Crowne Plaza  
4315 Midway Road (North of I-635), Addison, Texas 75001  
800/377-9778, Local 972/980-8877, Fax 972/788-9778

## Decorating Company

Freeman Company, Exhibit Services Department for additional tables, chairs, etc. – 214/634-1463, Fax 214/634-2221

**Set Up** Thursday, June 25, 2009 1:00 p.m. – 6:00 p.m.

**Exhibit Hours** Friday, Saturday, June 26-27, 2009 8:00 a.m.– 6:00 p.m.  
Sunday (optional), June 28, 2009 8:00 a.m.– 1:00 p.m.

**Dismantling** Saturday, June 27, 2009 after 7:00 p.m.  
or Sunday, June 28, 2009 after 1:00 p.m.

## Additional Benefits

- A hospitality bag will be distributed to all attendees. Exhibitors are encouraged to send 200 pieces of your company's literature/materials to us by May 1, 2009. The literature/materials should be no bigger and 8½" x 11" x ¼."
- Complimentary conference registration, syllabus and program for two representatives of your company.
- Refreshment breaks in exhibit room Friday, Saturday, and Sunday morning.
- Thursday lunch with all conference participants.
- Friday Evening Reception with participants in the exhibit room.
- Saturday Buffet Lunch with participants in exhibit room.
- Listing in the Symposium program with brief description of your company.
- A final listing of participants (mailed approximately 3 weeks after the conference.)

**Cost Per Space:** \$1,300.00

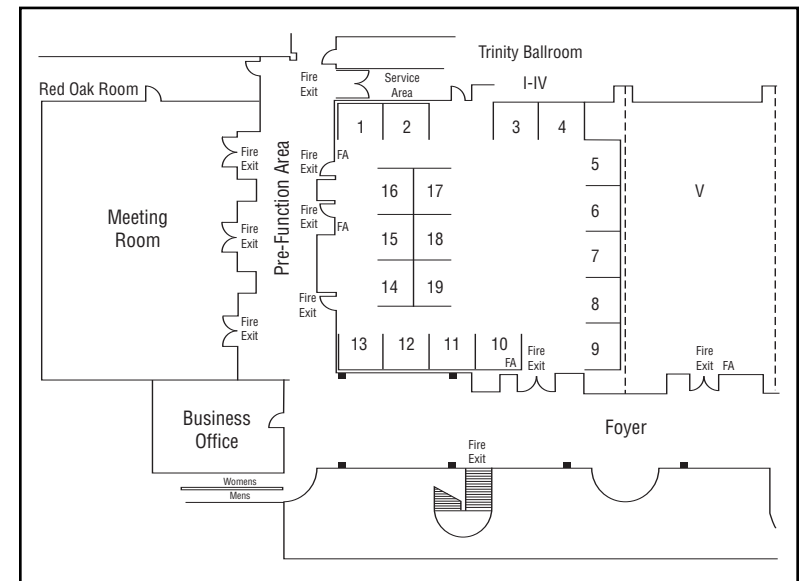

## Meeting Contact

### David Hicks

American Environmental Health Foundation, Inc.  
8345 Walnut Hill Lane, Suite 225  
Dallas, Texas 75231  
214/361-9515, Fax 214/361-2534  
e-mail: [symposium@aehf.com](mailto:symposium@aehf.com)



Since 1981, the International Symposium has been recognized as one of the most advanced medical forums in the world addressing the research and treatment of environmental effects on health and disease. The 2009 conference will focus on “Nutritional and Environmental Aspects of Cardiovascular Disease.” For this year’s conference, we have assembled a faculty of top international experts for you. This Conference presents the most current information available while providing guidelines to identify, diagnose, and treat and to prevent environmentally triggered responses in the body.

## Meeting Goals

- Provide new insights into the mechanisms and the environmental causes behind many problems seen by the physician.
- Present new diagnostic and treatment modalities to help improve the quality of care for complex patients.
- Provide concepts and tools that will enhance the physicians practice.

## Meeting Objectives

- Improve the outcome of treating patients cardiovascular disease.
- Use new concepts and treatments to help better diagnose and manage many patients with cardiovascular disease.
- Apply the concepts of this conference by using nutrition and environmental manipulation for the treatment cardiovascular disease.
- Use the information presented to enhance the effectiveness, cost-efficiency, and competitiveness in relation to cardiovascular disease.

## Intended Audience

M.D.’s, D.O.’s, D.D.S.’s, medical students, nurses, nutritionists, and other health professionals interested in the concepts and practice of Environmental Medicine, Occupational Medicine and Toxicology.

## Accreditation

### Physician Accreditation/Credit:

This activity has been planned and implemented in accordance with the Essential Areas and policies of the Accreditation Council for Continuing Medical Education through the joint sponsorship of the University of North Texas Health Science Center at Fort Worth Office of Professional and Continuing Education and the American Environmental Health Foundation. The University of North Texas Health Science Center at Fort Worth Office of Professional and Continuing Education is accredited by the ACCME to provide continuing medical education for physicians.

The University of North Texas Health Science Center at Fort Worth is accredited by the American Osteopathic Association to award continuing medical education to physicians.

## Credit

The University of North Texas Health Science Center at Fort Worth designates this educational activity for a maximum of *20.5 AMA/PRA Category 1 Credit(s)*.™ Physicians should only claim credit commensurate with the extent of their participation in the activity.

The University of North Texas Health Science Center anticipates this program for 20.5 hours in Category 2A, AOA credit hours, pending approval by the American Osteopathic Association CCME.

### Nursing Accreditation/Credit:

The University of North Texas Health Science Center at Fort Worth is an approved provider of continuing nursing education by the Texas Nurses Association, an accredited approver by the American Nurses Credentialing Center’s Commission on Accreditation.

This activity meets Type I criteria for mandatory continuing education requirements toward relicensure as established by the Board of Nurse Examiners for the State of Texas.

This activity is approved for a maximum of 20.5 Type 1 Contact Hours TNA/ANCC. To receive a certificate of successful completion, participants must attend the activity and complete and return the attendance record/credit request form and the evaluation form at the end of the activity.

## Educational Format

- Plenary
- Panel Discussion
- Case Studies
- Questions & Answers



## Important Information

- Cellular telephones are not permitted in the meeting room
- Smoking is prohibited
- Wearing of perfume or scented aftershave is prohibited
- No audio or video recording

## (Tentative Schedule)

### Thursday, June 25, 2009

Registration .....	7:30 a.m. – 8:00 a.m.
Conference Open .....	8:00 a.m. – 6:00 p.m.
Morning Coffee Break .....	10:00 a.m. – 10:30 a.m.
Luncheon .....	12 Noon – 1:30 p.m.
Exhibitor Set Up .....	1:00 p.m. – 6:00 p.m.
Afternoon Break .....	3:00 p.m. – 3:30 p.m.
Adjourn .....	6:00 p.m.
Exhibitor Set Up .....	10:00 a.m. – 6:00 p.m.

### Friday, June 26, 2009

Exhibit and Conference Open .....	8:00 a.m. – 6:00 p.m.
Morning Coffee Break .....	10:00 a.m. – 10:45 a.m.
Open Lunch .....	12 Noon – 1:30 p.m.
Afternoon Break .....	3:00 p.m. – 3:45 p.m.
Reception .....	6:00 p.m. – 7:00 p.m.

### Saturday, June 27, 2009

Exhibit and Conference Open .....	8:00 a.m. – 6:00 p.m.
Morning Coffee Break .....	10:00 a.m. – 10:45 a.m.
Buffet Lunch .....	12 Noon – 1:30 p.m.
Afternoon Break .....	3:00 p.m. – 3:45 p.m.
Exhibition Breakdown* .....	6:00 p.m.

### Sunday, June 28, 2009

Conference .....	8:30 a.m. – 12 Noon
Morning Coffee Break .....	10:00 a.m. – 10:30 a.m.
Closing & Exhibitor Breakdown* .....	1:00 p.m.

\*Exhibitors can breakdown Saturday evening or Sunday afternoon.

# General Exhibitor Information

In keeping with the principles of environmental medicine, please refrain from smoking or wearing scented toiletries and hair products during the Symposium. All representatives must be registered with the American Environmental Health Foundation (AEHF). Each exhibitor will receive a list of the registered meeting attendants approximately three (3) weeks after the end of the Symposium.

## Booth Description

Booths are 10' x 8' and carpeted. The show color is blue, which will prevail on the 3' high side rails, skirted table and back drapes. Your booth space includes two chairs, one eight foot exhibit table, and trash can. Electricity for your booth can be ordered from the hotel.

Exhibits must be arranged so as not to obstruct the view or otherwise interfere with the displays of other exhibitors. This restriction includes person(s), things, conduct, printed material or anything of a character which may be objectionable to the exhibits as a whole. In the event of such restriction or eviction, AEHF is not liable for any refunds, rentals or other exhibit expense.

## Signs

A seven inch by forty-four inch I.D. sign will be furnished to each exhibitor.

## Contract For Space

A deposit of \$650 is required when the exhibitor submits the contract for space, contingent upon satisfactory assignment, and prior to May 1, 2009. The balance is due no later than May 1, 2009. Failure to submit the full amount by this date may result in cancellation of the space and a forfeiture of the deposit. Applications received after May 2, 2009 must be accompanied by full payment.

## Shipping Instructions

Your Exhibitor Packet (will be e-mailed to you by Freeman) will contain information on all shipping information. Exhibitors are encouraged to coordinate deliveries with the official contractor because of limited accessibility to the loading dock.

## Cancellations

All cancellations must be in writing. If the exhibitor cancels the space before May 1, 2009, AEHF will retain or collect 50% of the exhibitor's total contract obligation. If the exhibitor cancels space after May 1, 2009, AEHF may retain or collect up to 75% of the total exhibit fee. If the exhibitor cancels the space less than 10 days prior to the exhibit opening, AEHF may collect up to 100% of the exhibitor's contract obligation. In the

event the cancelled space is resold, AEHF will refund 75% of the cancelled exhibitor's payment.

## Failure To Occupy Space

Any exhibitor failing to occupy space is not relieved of the obligation to pay full rental price for such space. AEHF shall have the right to use unoccupied space as it sees fit.

## Space Selections

Please review the enclosed floor plan carefully and select three (3) exhibit choices. Indicate these choices on the application for space. Due to the fact that prime locations sell quickly, please indicate the alternate booths you will accept. If the selected booths are not available at the time the application is received, the exhibitor will be contacted by AEHF. Return the application, along with a deposit to AEHF before May 1, 2009.

## Security

Neither AEHF, the University of North Texas Health Sciences, nor the Crowne Plaza Near the Galleria, nor their officers, directors, employees, agents, or members will be liable for the safety of participants, property, or that of their employees or agents from theft, damage by fire, accident or other causes. Participants are advised to consult their insurance broker for proper coverage on display material. In most cases, a rider can be added to a current policy for a very nominal cost.

## Restrictions

The exhibitor agrees that his exhibit shall be admitted and **shall remain** from day to day solely in strict compliance with the rules herein laid down. AEHF reserves the right to reject, eject, or prohibit any exhibit, in whole or in part, or any exhibitor or his representatives, with or without giving cause. If cause is not given, liability shall not exceed the return to the exhibitor of the amount of rental unearned at the time of ejection. If an exhibit or exhibitor is ejected for violation of these rules or for any other stated reasons, AEHF is not liable for any refunds, rentals or other exhibit expenses.

AEHF shall have the sole authority to interpret and enforce all rules and regulations contained herein and to make such further rules and regulations as shall be necessary for the orderly conduct of the exhibit area.

## Use Of Space

All demonstrations, interviews, or other sales activities must be confined to the limits of the booth space. Participants may not assign or sublet any allotted space and may not advertise, display, or otherwise promote

goods or services other than those manufactured, distributed, or sold by it in the regular course of business without prior authorization of AEHF. Aisles must be kept clear at all times.

Advertising, canvassing, selling, taking orders, and/or conferencing (in the interest of business) in the Meeting Room is strictly forbidden. Further, exhibitors selling tangible goods must meet requirements of the City of Richardson.

## Badges And Booth Staffing

Each exhibit company is limited to two representatives at one time in the booth. Identification badges for up to three (3) representatives will be printed and placed in exhibitors' registration packets to be picked up at Registration Desk. CME's are available to representatives for an additional cost of \$200 per person.

## Set Up

Exhibitors can set up on Thursday between 1:00 p.m. and 6:00 p.m. The Freeman Company will have a representative on-site to assist exhibitors.

## Dismantling

Dismantling may begin Saturday, June 27, 2009, after 7:00 p.m., or Sunday, June 28, 2009 at 1:00 p.m. The Freeman Company will have a representative on-site to assist exhibitors with outbound freight shipments on Sunday, June 28, 2009.

## Hospitality Bag

A hospitality bag will be distributed to all attendees. Exhibitors are encouraged to send 200 pieces of your company's literature/materials to us by May 1, 2009. The literature/materials should be no bigger and 8½" x 11" x ¼."

## Nonliability

It is mutually agreed by and between the American Environmental Health Foundation, Inc. (hereinafter "AEHF"), the University of North Texas Health Science Center (hereinafter PACE) and the exhibitor that AEHF and PACE shall have no liability whatsoever to an exhibitor, his employees or his business invites, nor any liability for loss or damage to the property of the exhibitor, his employees or business resulting from any cause. It is further understood and agreed that all claims against AEHF or PACE for any such damage, loss or injury are expressly waived by the exhibitor.

## Catastrophe

No combustible decoration may be used at any time.

## Hotel Accommodations



The Crowne Plaza Hotel North Dallas/Addison will be the headquarters for this year's conference. This business class hotel is located in Addison Texas, a suburb of North Dallas. The hotel offers first-rate accommodations and is minutes from downtown Dallas, DFW airport, world class shopping, dining and recreation.

The Crowne Plaza is offering a special room rate for Symposium attendees until June 1, 2009. The room rate is \$105 per night from June 24-28, 2009. (Reservations 800/377-9778 or [cpgalleria-nr.crowneplaza.com](http://cpgalleria-nr.crowneplaza.com). The group discount code is UDA.



14315 Midway Road • Addison • TX 75001



## AEHF History

The American Environmental Health Foundation (AEHF) was founded in 1975 as a nonprofit organization to provide research and education into Chemical Sensitivity and Environmental Illness. Over the past 33 years A.E.H.F. has funded more than 30 major medical research projects and sponsored numerous conferences for both the health professional and the general public.

Funding for our research and education comes from donations and the proceeds from the Foundation Store, Internet and catalog sales. The AEHF store carries more than 1,600 environmentally safe products for the home, office and school.



## Transportation

The Crowne Plaza Hotel is located in Addison Texas, a suburb of North Dallas on Midway Road near LBJ Freeway (I-635). D/FW International Airport and Dallas Love Field are about 30 minutes from the hotel. Taxi and shuttle service is available to and from both airports. The each way rate for DFW is approximately \$50 and Dallas Love Field is \$35.

**Yellow Cab** – 214/426-6262

**Taxi Dallas** – 214/821-8294

